

Series
AE

Terminal block 14,3

Issue :
jun 17th, 2016

Page
1/1

| Part number | # of Poles | Dimensions | | Part number | # of Poles | Dimensions | |
|-------------|------------|------------|--------|-------------|------------|------------|--------|
| | | A | B | | | A | B |
| PS AE ###01 | 1 | 39,12 | 28,70 | PS AE ###14 | 14 | 224,79 | 214,38 |
| PS AE ###02 | 2 | 53,34 | 42,93 | PS AE ###15 | 15 | 239,01 | 228,60 |
| PS AE ###03 | 3 | 67,56 | 57,15 | PS AE ###16 | 16 | 253,24 | 242,82 |
| PS AE ###04 | 4 | 81,79 | 71,37 | PS AE ###17 | 17 | 267,72 | 257,30 |
| PS AE ###05 | 5 | 96,01 | 85,85 | PS AE ###18 | 18 | 281,94 | 271,53 |
| PS AE ###06 | 6 | 110,49 | 100,08 | PS AE ###19 | 19 | 296,16 | 285,75 |
| PS AE ###07 | 7 | 124,71 | 114,30 | PS AE ###20 | 20 | 310,64 | 300,23 |
| PS AE ###08 | 8 | 138,94 | 128,52 | PS AE ###21 | 21 | 324,87 | 314,45 |
| PS AE ###09 | 9 | 153,42 | 143,00 | PS AE ###22 | 22 | 339,09 | 328,68 |
| PS AE ###10 | 10 | 167,64 | 157,23 | PS AE ###23 | 23 | 353,57 | 343,15 |
| PS AE ###11 | 11 | 181,86 | 171,45 | PS AE ###24 | 24 | 367,79 | 357,38 |
| PS AE ###12 | 12 | 196,09 | 185,67 | PS AE ###25 | 25 | 382,02 | 371,60 |
| PS AE ###13 | 13 | 210,57 | 200,15 | PS AE ###26 | 26 | 396,24 | 385,83 |

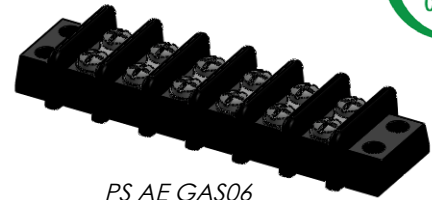

PS AE GAS06

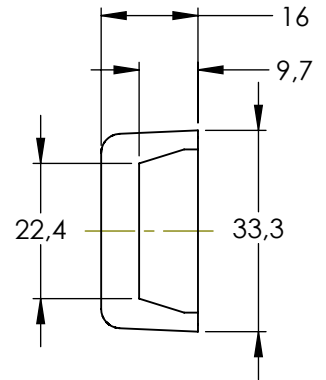
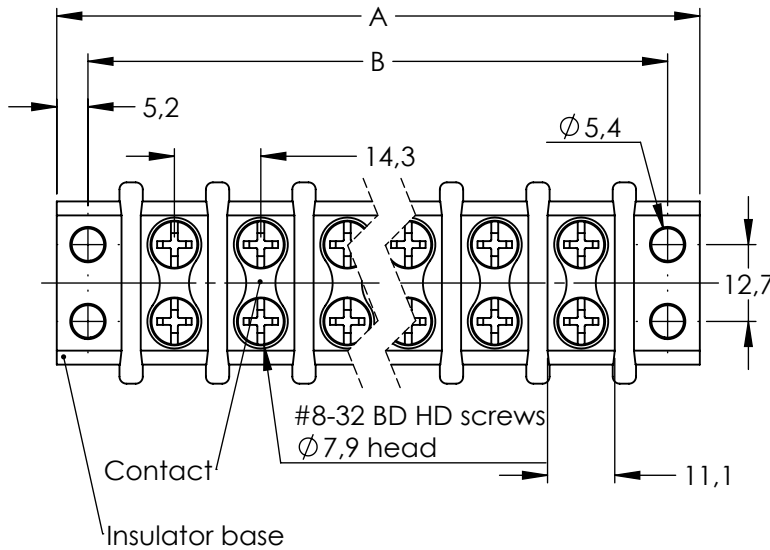

Materials :

- Contact : Brass, nickel plated.
- Insulator base : General Phenolic (-40°C to 150°C) UL 94 V1. Diallyl phthalate, glass-fiber filler UL-94 V0
- Screw, #8-32 Binder head, Phil-Slot : Steel, nickel plated or Brass.

Electrical characteristic :

- Voltage : 300V AC/DC.
- Nominal current : 30A.
- Short Circuit Current Rating : 10 000A (Default).

Accessories :

- Printing following customer specification.
- Marking strips - sub mounted*.
- Marking strips - top mounted*.
- Insulator strips - sub mounted*.
- Cover - top mounted*.

* See Accessories Technical Data Sheet.



Print option.



How to order :

| Descriptions | Reference | Base Material | Contact type | Screw type | nb of poles |
|----------------|-----------|---------------|--------------|------------|-------------|
| Ordering Codes | PS AE | G D | A | S B | 01 to 26 |

G : General Phenolic
D : Diallyl Phthalate

S : Steel screws
B : Brass screws

This information is given as an indication in the continual goal to improve our products, we reserve the right to make any modifications judged necessary.

DIMENSIONS : mm [inch are given for information only]

CREATION

PROJET :

NAME : GIRARDOT C.

DATE : jun 17th, 2016

APPR : CHEVREAU M.

| Issue | Revisions | Name | Approved |
|-------|-----------|------|----------|
| | | | |
| | | | |
| | | | |
| | | | |
| | | | |

This document is the property of PASMAN. It cannot be reproduced or communicated to a third party without a prior written permission.

www.pasman.fr