

Series  
**TB**

**TB8 connector**  
for disconnect and PCB application

Issue :  
Nov 20th, 2018

Page  
**1/1**

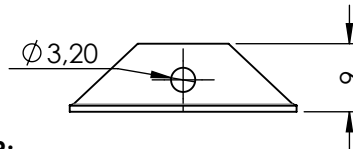
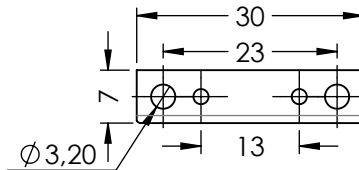
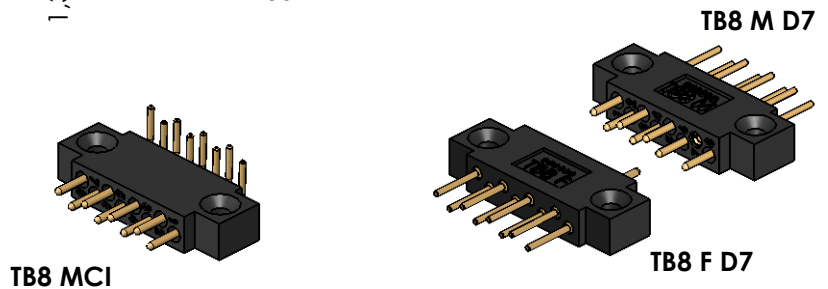
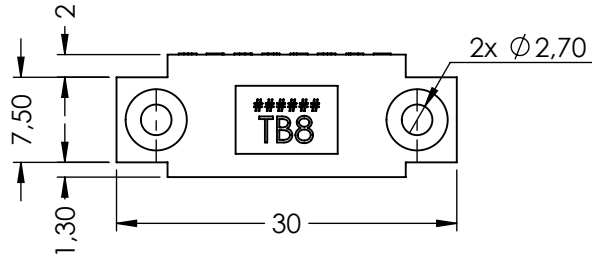
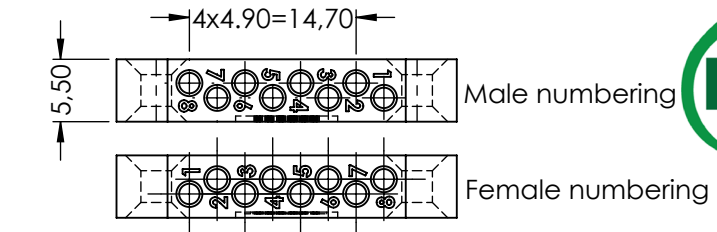
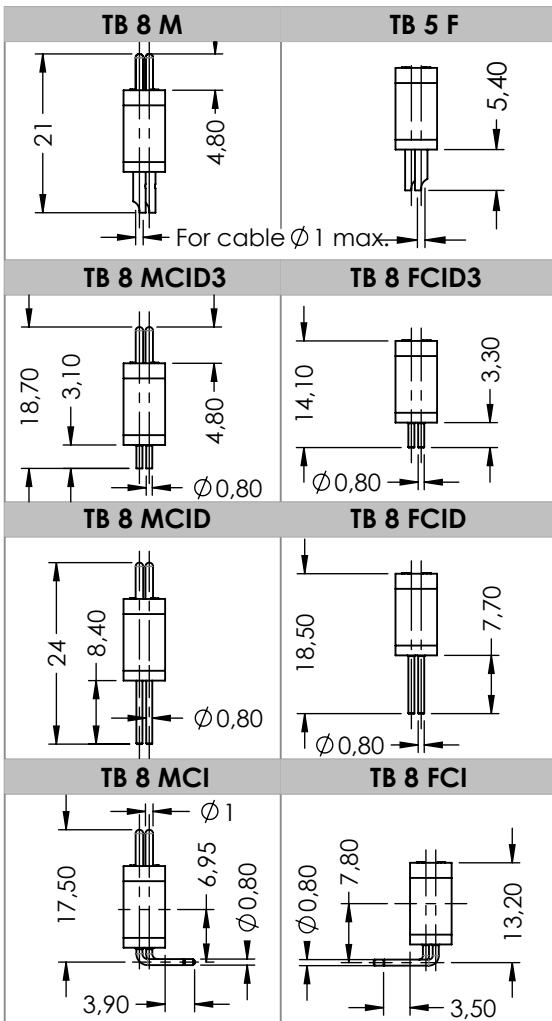

**Fixing bracket**  
(see note)

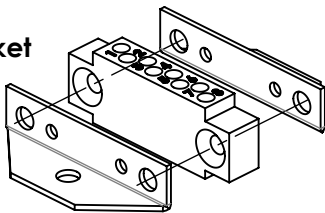

**HOW TO ORDER:**

**Contact style** (see table) :

- M
- MCID
- MCI
- F
- FCID
- FCI

**TB 8 # #**

**Polarization (option) :**

D1 to D8 for inverted contact position

**TECHNICAL CHARACTERISTICS:**

- Insulating body: Thermoplastic UL V0
- Test voltage between contacts: 1500V.
- Nominal current: 5A.
- Average extraction effort: 0.8 to 1.2N/contact
- Contacts resistance: < 0.005Ω
- Insulating resistance/500V: > 10<sup>3</sup> MΩ
- Working voltage: 250V

**POLARIZATION:**

- Ensured by the inversion of 1 pin and 1 socket contact

**NOTES:**

- The TB8 connector may be used to form rack connectors
- Fixing bracket : P/N R39900000005A - Équerre TB
- Ask us for special customer contact composition
- TB8 MCID / MCI / FCID / FCI only on request

**DIMENSIONS : mm [inch are given for information only]**



**CREATION**  
**PROJET :**  
**NAME : MAGNE G.**  
**DATE : Nov 20th, 2018**  
**APPR : CHEVREAU M.**

Issue	Revisions	Name	Approved

This document is the property of PASMAN, It cannot be reproduced or communicated to a third party without a prior written permission.

This information is given as an indication in the continual goal to improve our products, we reserve the right to make any modifications judged necessary.